



WHITEHAVEN HARBOUR CLASSIC 40

**CUSTOMISE. PERSONALISE.
IT'S YOUR JOURNEY, MAKE IT A WHITEHAVEN.**

At Whitehaven, we put you and your experience at the heart of the design process. Being a truly bespoke boat builder we offer an exceptional level of customisation. Every Whitehaven is unique, just like their owners, so let us guide you through the journey of creating your ultimate luxury entertainers motor yacht.



WHITEHAVEN

MOTOR YACHTS

your journey. your whitehaven.

WHITEHAVEN HARBOUR CLASSIC 40

SPECIFICATIONS*

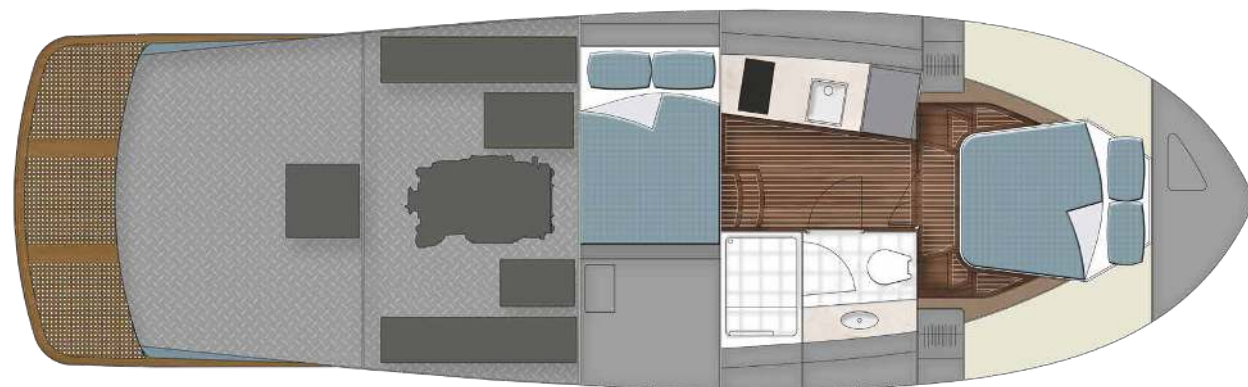
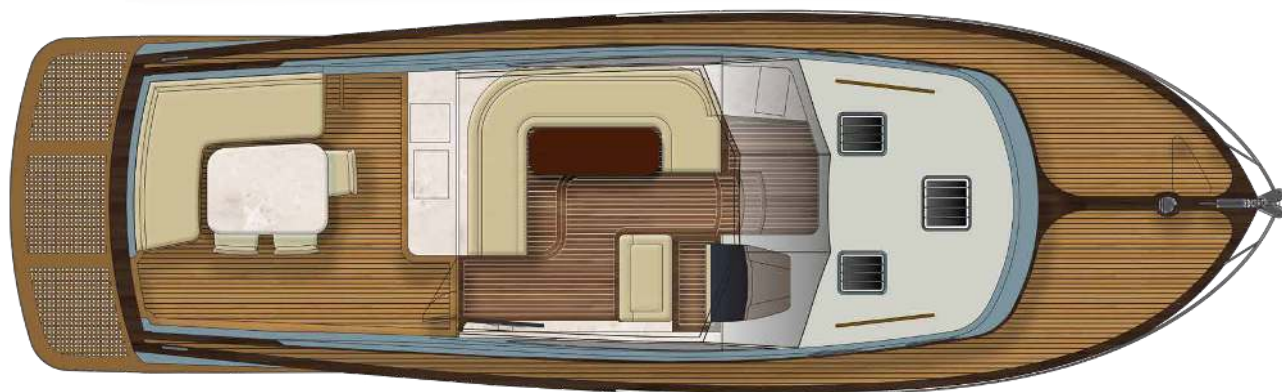

— WHITEHAVEN —

www.wmy.com.au

Phone 1300 758 896

WHITEHAVEN HARBOUR CLASSIC 40

SPECIFICATIONS*

WHITEHAVEN HARBOUR CLASSIC 40

Engine	Single Volvo D6 480hp with ZF gear box inc. electronic controls
Length Overall (inc, swim platform)	12.9m / 42' 3"
Beam (Max.)	3.9m / 12' 8"
Draft (Approx.)	0.9m / 2' 9"
Dry Weight (Approx. - Subject to change with engine options)	8100kgs
Sleeping Capacity (approx.)	4 persons
Fuel Capacity (approx.)	800 litres
Water Capacity (approx.)	450 litres
Holding Tank Capacity (approx.)	101 litres



Extended Roofline Option

WHITEHAVEN

www.wmy.com.au

Phone 1300 758 896

WHITEHAVEN HARBOUR CLASSIC 40

BASE SPECIFICATIONS*

ENGINE AND GEARBOX

Single Volvo D6 480hp with ZF gear box inc. electronic controls

CONSTRUCTION

Hull moulded GRP gelcoat finish in selection of standard colours

Hull top sides core reinforced for light weight

Deckhouse moulded GRP vanilla gelcoat

Independent compartments and stringer system

Solid hull bottom with chines to waterline

Vinyl ester resin used in first outer layer of hull

Water tight collision bulkhead forward

Moulded one piece fibreglass deck and enclosed hard top

MECHANICAL & ELECTRICAL

Acoustic and thermal insulation throughout engine room

Battery paralleling system for emergency engine start

Batteries 1 x 80amp Genset Start

Batteries 2 x 200 amp House 12v power maintenance free

All AC power outlets RCD protection

All batteries fitted in battery boxes

Northern lights 4KVA Genset with muffler, water cooled

All hoses double hose clamped

Battery charger 12V for house and start bank 600amps

Bilge pump auto and manual override high water alarms x 4

Bonding system to all hull fittings, zinc anode incl. galvanic isolator

Tinned electric wiring. Where applicable coded and labelled

Trim tabs Interceptor style (Zip) with controls at helm

Ventilation system to include blowers for engine room

Bow thruster electric 12V, controls at helm

Stern thruster electric 12V, controls at helm

Engine mounts anti-vibration

Engine room lighting DC

Fire extinguishing system for engine room

Seaward 6G fresh water heater AC 60L

Fresh water pressure pump high volume 12v

Fresh water tank s/steel 450ltrs

Fuel filters (Racor) for main engine and Genset.

Fuel lines in copper or USCG all hoses

Fuel tank 800ltrs with sight gauge & emergency cut off

Holding tank 101ltrs (approx)

Hull fittings brass fitted with ball valves

LED lighting throughout 12V

Manual hand operated bilge pump

Navigation lights LED international compliant

LED strip lighting under valances in saloon, galley & stateroom

Seawater pump for foredeck and cockpit

Seawater strainers for engines, genset

Shore power lead.

COCKPIT

Aft seating (L shaped) upholstered lounge with folding table

Refrigeration (Vitrofrigo 70ltr drawer type) to console unit

Storage drawer to console unit in lieu of optional 2nd Vitrofrigo drawer freezer

Engine room access hatch lockable

Direct and courtesy lighting

Hand held shower hot/cold

Transom door GRP, opening outwards

Swim platform teak laid inserts

Flagpole

DECK

Anchor 16kg (35lbs), 8mm galvanised chain by 60m

Anchor locker accessed by 2 anchor lock hatches on deck

Anchor chain safety strap

Bow roller stainless steel self loading

Bow rail 316 stainless steel flag staff at bow

Cleats stainless steel x 6, (bow x 2, spring x 2, and stern x 2)

3 x stainless steel hatches (1 x Escape) to forward deck

Fuel fillers on side decks

Fwd windscreen in safety glass bonded to FRP frame

Rub Rail stainless steel

Winch electric 12V vertical, foot switches & remote at helm

Non-slip to fwd & deck sides

Side windows tempered glass to FRP house frame

Stainless steel swim ladder

Hand rail stainless steel to roof top

Wash down tap (sea water & fresh) in anchor locker

INTERIOR

Teak or oak timber in satin finishes

Headliner in high quality upholstered vinyl with wood trim design features

High quality vinyl flooring to saloon, galley, forward cabin & bathroom

WHITEHAVEN

www.wmy.com.au

Phone 1300 758 896

WHITEHAVEN HARBOUR CLASSIC 40

BASE SPECIFICATIONS*

SALOON

Direct, indirect and courtesy LED lighting

Tinted glass for saloon windows

U-Shaped dinette with timber table

Wabasto hatch to roof (Manual opening)

Fully enclosed glass bulkhead with s/steel frame inc. lockable door & hopper window

TV to saloon (drop down starboard side opposite dinette)

Fusion sound system Bluetooth connectivity with, speakers to salon and cockpit

Double GPO (pop up)

HELM

Double helm seat (cozy) with adjustable slider & footrests

Opening starboard side window adjacent helm seat

Dash surfaces in high quality vinyl finishes

Raised dash pod for navigation equipment in matching vinyl finish

Electronic engine/s controls

Bow and stern thruster controls

Windscreen wipers x 3 and washers

Trim tab controls and indicator

Horn and wiper switches

Navigation and anchor light switches

Fuel and water gauges

Compass

VHF radio

Drink holder

GALLEY

Storage lockers

Bench-top with storage cabinets & draws below bench

Single lever mixer tap to galley sink

Refrigerator with freezer (DC)

Microwave

Hatch stainless steel to roof

2 burner AC cooktop

Dishwasher

Double GPO

STATEROOM FORWARD

Hanging locker stbd /port cedar lined with auto lighting DC

Private entrance to forward cabin

Hatch stainless steel (escape) to roof

Head board upholstered

Storage cabinet underneath berth incl. Draw units & gas strut for easy access

Open bed (double)

Mattress drawers and storage

Reading lights

Double GPO

DAY HEAD / BATHROOM

Bench-top including basin and mixer tap

Entrance door

Lighting overhead vanity DC

Wall mirror

Extraction fan

Shower with glass door

Shower head handheld

Toilet roll holder

Towel rail

Under bench vanity draw and shelf storage

Vacuflush toilet

Vanity cabinet above sink

Hatch Stainless Steel to roof

Double GPO

DAY/NIGHT BED

Midship open bed (double)

Mattress

Headboard upholstered

Reading lights

Storage locker outboard

GENERAL

Soft furnishings package

Antifouling 2 x coats epoxy undercoat and 2 x coats antifoul

External block out covers to windcreens and saloon side windows

Fenders x 3

Docking lines x 3

At Whitehaven, we proudly stand behind the finish and performance of our vessels. For your peace of mind, we offer an exceptional 5 year hull and structural and 3 year Whitehaven manufactured item warranty.

WHITEHAVEN

www.wmy.com.au

Phone 1300 758 896

WHITEHAVEN HARBOUR CLASSIC 40

PRICING*

WHITEHAVEN HARBOUR CLASSIC 40 (AUD)** **\$766,000**

Base Price with Single Volvo D6-480hp with ZF gear box inc electronic controls, Single station, or
Optional Single Diesel - Cummins QSB 6.7 480hp with ZF gearbox inc electronic controls. Single station.

ENGINE UPGRADE

Single Diesel - Cummins QSB 6.7 550hp with ZF gearbox inc electronic controls	\$20,112
Twin Volvo D4-300DPI. Single station Joystick with electronic controls	\$53,142
Twin Volvo D6 IPS400 Single station Joystick with electronic controls	\$111,460

MECHANICAL AND ELECTRICAL

Seakeeper 3 Stabiliser (operates on DC power)	\$56,762
Twindisc Express Joystick System (EJS) to include Quickshift transmission, EC300 single lever station, 2 x joystick stations with upgraded bow/stern thrusters to hydraulic. (Std with Twin Engine Upgrade)	\$66,818
Express Positioning System EPS (only available with EJS upgrade)	\$18,819
Upgrade to 24V DC electrical system	\$10,013
C-Zone fitted to 24V DC electrical system	\$17,664
Upgrade to Onan generator with auto start / stop function	\$5,887
Inverter 3KVA package and upgraded battery bank	\$13,099
Search light	\$1,600
Underwater lights x 2 fitted to transom	\$1,694
Anchor chain counter	\$794
Stainless steel skin fitting upgrade	\$2,584

DECKHOUSE

Extended hardtop roof to cover aft cockpit seating with feature stainless steel support posts	\$8,362
Sureshade electric retractable awning fitted (available with std short roof only)	\$16,010

FORWARD DECK AND SIDE DECKS

Upgraded bow rail to oval stainless steel style.	\$2,646
Stainless steel chafe plates fitted to all cleat locations	\$1,600

Specifications as of July 2020. *This pricing and specification is subject to change without notice **Price based on US exchange rate of 0.73 Delivery Brisbane

WHITEHAVEN

www.wmy.com.au

Phone 1300 758 896

WHITEHAVEN HARBOUR CLASSIC 40

PRICING*

COCKPIT

Additional Vitrofrigo drawer type freezer x 70 ltr to console unit in lieu of storage drawer	\$5,386
Teak laid to cockpit	\$9,923
Upgrade cockpit table to teak laid finishes and slide mechanism hi/low to coffee table in lieu of folding top	\$3,969
Upgrade cockpit seating to premium Silververtex vinyl outdoor fabrics with stitched strap detail	\$7,682

SALOON / INTERIOR

Air conditioning 12,000 BTU with additional outlets to helm	\$14,819
Upgrade to premium Italian leather with diamond stitched finishes to helm seat, backrest carcass and dinette.	\$18,386
Webasto roof hatch to electric operation	\$7,472
Upgrade to electric raise / lower helm side window.	\$9,923
Vitrofrigo ice maker fitted below helm seat	\$5,264
Teak and Holly (Nautikflor) high quality vinyl flooring	\$3,850
Timber interior finish upgraded to satin walnut	\$5,300
Timber interior finishes in high gloss or contrasting Majilite fabrics to walls, dash and helm pod	\$4,500

GALLEY / LOWER ACCOMMODATION

Air conditioning to lower accommodation 12,000 BTU	\$17,796
Upgrade to premium Italian leather and diamond stitched bed heads	\$1,448
Upgrade from Staron to Corian bench tops	\$3,974
Upgrade to premium galley tapware	\$728

HULL COLOUR

Painted hull, topsides, lower deckhouse (customer specific)	\$POA
---	-------

EXTERIOR CANVAS / COVERS

External breezeway covers to windscreens and saloon side windows	\$1,602
Cockpit storm covers (incl zipper access at transom door – long roof option only)	\$3,781
Infills to cockpit qrtr panel in Plexi-glass	\$2,805

NAVIGATION PACKAGE

Garmin 12" multi-function display, chart card, transducer, GPS and VHF	\$12,500
--	----------

Specifications as of July 2020. *This pricing and specification is subject to change without notice. **Price based on US exchange rate of 0.73 Delivery Brisbane

WHITEHAVEN

www.wmy.com.au

Phone 1300 758 896